



AYVAZ

Butterfly Valve

(KV 4)

KV 4

BUTTERFLY VALVE
Hand Lever (PN 10/16)



Main Features

AYVAZ KV 4 Lug Type Butterfly Valves are designed for installation between flanges drilled in accordance with DIN standard and with the hand lever operation.

Applicable fluids : Water, warm water, sea water, air and weak acid.

- For other kinds of applicable fluids except the above, to which **The Butterfly Valve** becomes applicable, please kindly consult to our SALES DEPARTMENT.

- Ordering the various kinds of **AYVAZ Butterfly Valve**, please refer to Order Code for detail.

Typical Applications

Heating, ventilating and air conditioning Water treatment and distribution systems

Mining industry

Shipbuilding and off-shore industries

Chemical and petrochemical plants

Sugar industry

Food and chemistry processing

Oil and gas process

Fire fighting and sanitary systems

Note

Gear Box recommended for sizes

DN 125 -DN 150 -DN 200.Above DN 200 we supply only with Gear Box.

OPERATING CONDITIONS	
Operating Pressure PMO (bar)	16
Operating Temperature TMO (°C)	130
Connection	Flanged
Flange Standard	DIN PN 10/16
Tightness	DIN 3230 T3/Leckrate 1

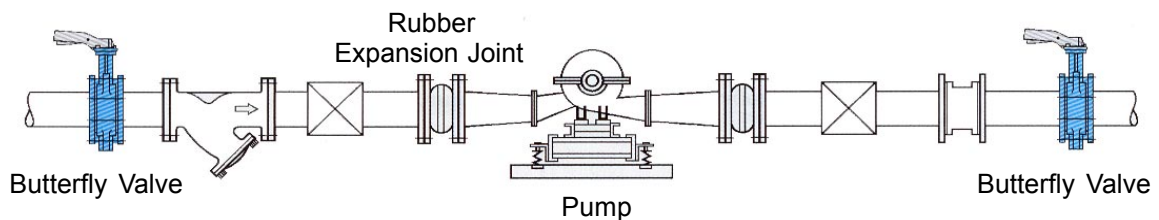

BUTTERFLY VALVE (PN 10/16)

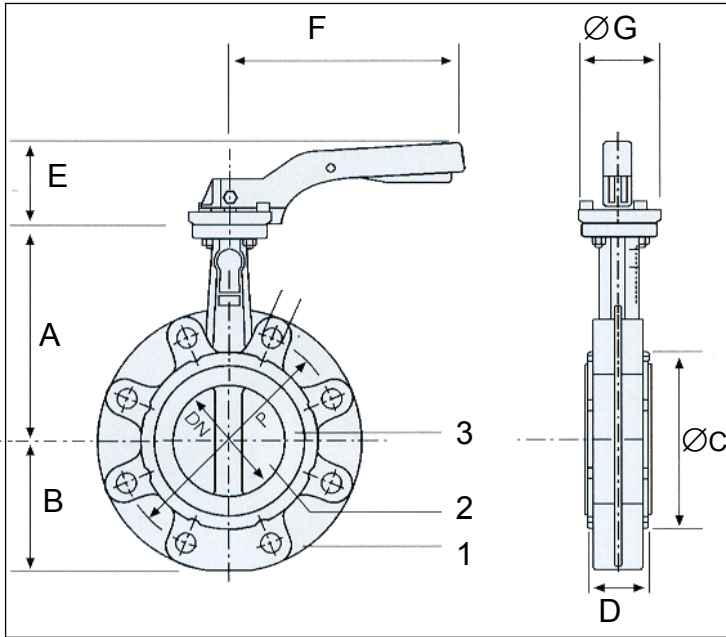

Other materials except above are available on request.

Material	
1 Body	Cast iron GG25 - Nodular iron GGG 40
2 Disc	AISI 316/Ductile iron with nickel plated
3 Liner	EPDM

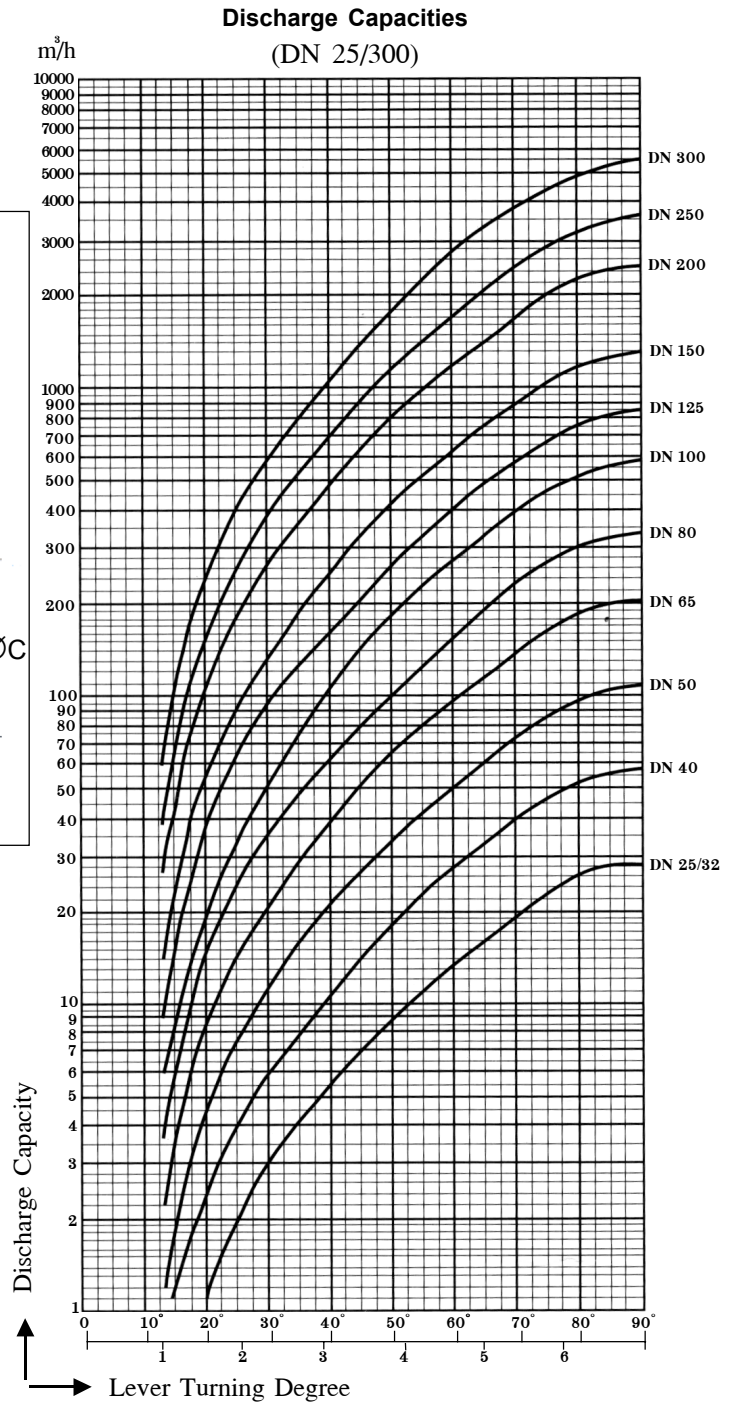

NOMINAL PIPE SIZE (DIN)		A	B	C	D	E	F	G	DIN STANDARD					
									PN 10			PN 16		
									P	d	n	P	d	n
mm	mm	mm	mm	mm	mm	mm	mm	mm	mm	mm	NOS	mm	mm	NOS
40	1-1/2	130	61	82	33	68	191.5	65	110	18	4	110	18	4
50	2	136.5	77	95	43	68	191.5	65	125	18	4	125	18	4
65	2-1/2	142	87.5	109	46	68	191.5	65	145	18	4	145	18	4
80	3	158	95	127	46	68	191.5	65	160	18	8	160	18	8
100	4	180	107	152	52	68	191.5	65	180	18	8	180	18	8
125	5	192	121.5	180	56	68	191.5	65	210	18	8	210	18	8
150	6	215	144	207	56	77	277	90	240	22	8	240	22	8
200	8	241.5	171	260	60	77	277	90	295	22	8	295	22	12